



READY TO BUILD PLANS

HOME & INCOME MULTI LIVING

185.6M²

Octave

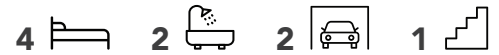

A cleverly designed home and income option for those that wish to maximise their investment opportunities, or house extended family.

There are two fully self-contained houses under one roof – a 3 bedroom main home, and a 1 bedroom secondary unit. The dwellings are separated by their garages – offering each home privacy and sound reduction. Each house has open plan areas for living, dining, kitchen, and internal access to the garage and laundry.

SPECIAL FEATURES

- Home and income opportunity
- Two dwellings under one roof – 3 bedroom house & 1 bedroom unit
- Open plan living, dining and kitchen
- Small, compact footprint perfect for a long narrow site

DIMENSIONS

Unit 1 Living Area	92.7m ²
Unit 1 Garage Area	21.7m ²
Unit 2 Living Area	50.3m ²
Unit 2 Garage Area	20.9m ²
Total Floor Area	185.6m ²
Overall Dimensions	20.9m x 15.0m

